

PIPINGNOW



✉ info@pipingnow.com

☎ 833-290-3800

🌐 PIPINGNOW.COM

FIG. 110CT
CLEVIS HANGER FOR COPPER TUBING

TUBE SIZE	TUBE OD	BOLT	A	B	C	E	F	WGT EACH (lbs)	MAX REC LOAD (lbs)
1/2	0.625	1/4	3/8	1-7/8	2-3/16	1-1/8	1/2	0.12	150
3/4	0.875	1/4	3/8	1-3/4	2-1/8	1	1/2	0.12	250
1	1.125	1/4	3/8	1-13/16	2-5/16	1-1/16	1/2	0.12	250
1-1/4	1.375	1/4	3/8	2-1/8	2-3/4	1-5/16	3/4	0.12	250
1-1/2	1.625	1/4	3/8	2-1/2	3-1/4	1-3/4	15/16	0.18	250
2	2.125	1/4	3/8	2-15/16	4	2-3/16	1-1/16	0.24	250
2-1/2	2.625	1/4	1/2	4-7/8	5-3/4	3-3/8	2-1/16	0.58	350
3	3.125	1/4	1/2	4-1/2	6-1/8	3-7/16	2	0.60	350
3-1/2	3.625	5/16	1/2	4-3/4	6-1/2	3-11/16	1-13/16	0.66	350
4	4.125	5/16	1/2	5-7/8	7-7/8	4-3/4	2-9/16	1.02	400
5	5.125	3/8	5/8	5-7/8	8-3/4	4-3/4	1-5/8	1.68	550
6	6.125	3/8	5/8	6-1/16	9	4-3/4	1-1/2	1.84	550

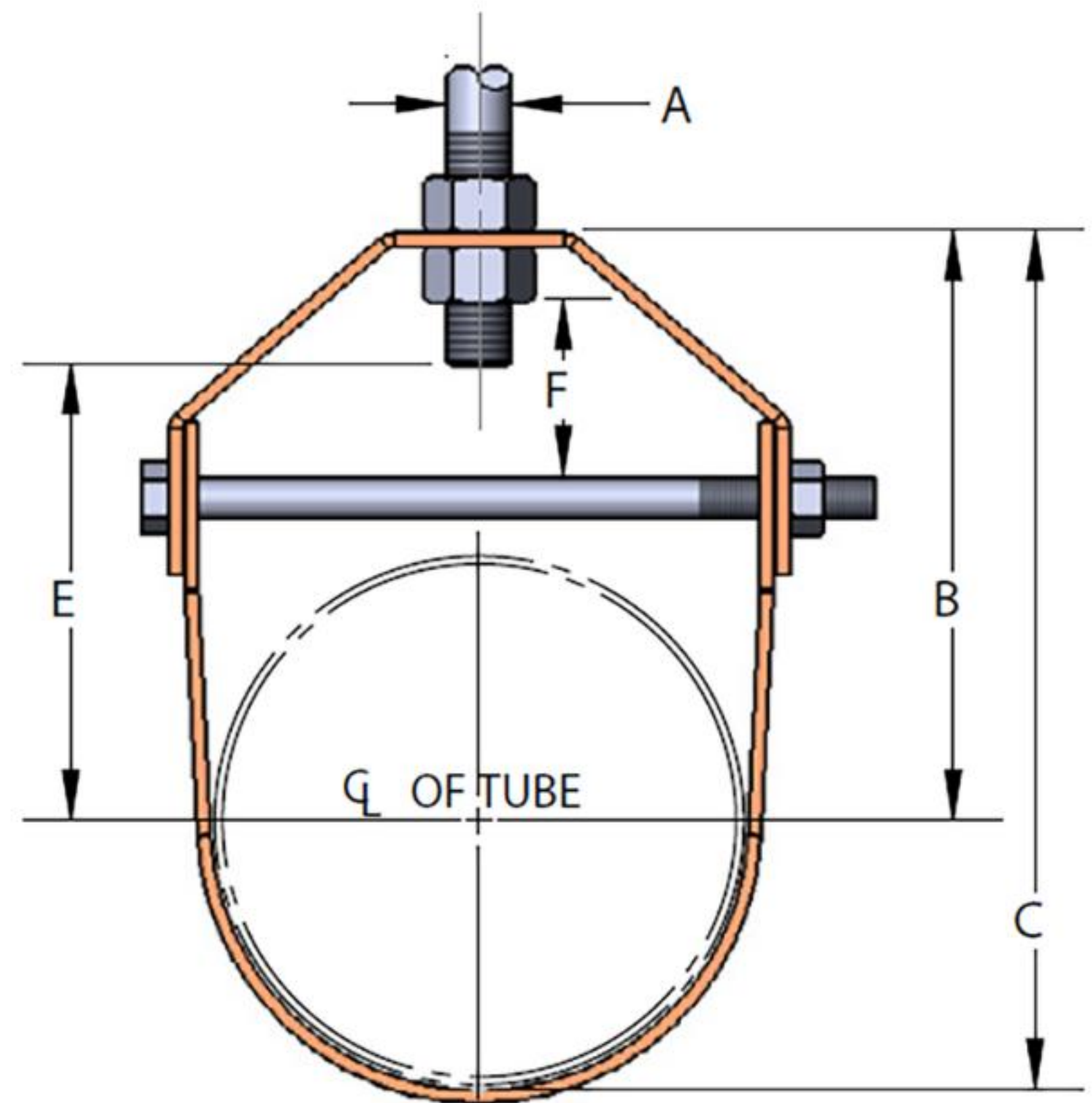

“E” dimension includes exposed rod threads beyond bottom of the hex nut. Exposed rod thread dimension is equal to the diameter of the rod used.

Materials/Finishes:	Copper Epoxy Coated <i>Copper Gard</i> : Domestic (110CT)
Variants:	Copper Epoxy Coated <i>Copper Gard</i> : Imported (110CTI)
Service:	Designed for the suspension of stationary copper tubing
Approvals:	Complies with Manufacturers' Standardization Society MSS SP-58 and SP-69 (Type# 1)
Ordering:	Specify figure number and tube size
Notes:	COPPER-GARD products offer superior corrosion protection due to the epoxy coating over phosphate zinc coated steel. The alternative copper plating that has been done historically identifies the product and is not intended for protection. Refer to MSS SP-58, 13.3.

